

Rotary Disconnect Switch, SE Series, 2-3-4 Poles, Type R, Door or Thru Panel Mounting



REGOLUS SWITCH DISCONNECTORS

The Giovenzana Disconnectors Regolus Series, built to the most stringent European and international standards (IEC / EN 60947-3, UL508), meets all the safety requirements.

The long industrial experience combined with the use of the best materials, plant and most modern design tools, enables us to produce a range of high quality equipment placing Giovenzana brand as synonymous of reliability, operational reliability and durability of its products.

SE SERIES

The disconnectors modular SE Series from 2 to 4 poles, from 32A to 100A allows to install IP20 terminal protections and auxiliary contacts (SE16-SE32 only).

GENERAL CHARACTERISTICS

- Rated current from 32A to 100A
- Series modular with 4 poles
- Matching with auxiliary contacts

AVAILABLE VERSIONS

- Panel mounting Screw Fixing
- Panel mounting Ø22,5mm Central Hole Fixing (SE16-SE32 only)
- Base Mounting
- Door locking

COMPLY WITH RULES

- IEC/EN 60947-3, UL508.
- IEC/EN 60947-5-1, UL508 (auxiliary contacts).

| SERIES | | | SE16 - SE32 | SE63 - SE80 SE100 | AUXILIARY CONTACTS | | | |
|----------------------------|--|--|--|--|--|-------|--------|--------------------|
| Protection class | control terminals | EN 60529 (UL50 ♦) NEMA 4X EN 60529 | IP65 (Type 1 - 4 - 4X) IP20 | IP65 (Type 1 - 4 - 4X) IP20 | - IP20 | | | |
| Material Group | | EN 60947-1 | II | II | II | | | |
| Pollution class | | EN 60947-1 | 3 | 3 | 3 | | | |
| Flammability | | UL94 | VO (Live Electric parts) | VO (Live Electric parts) | VO (Live Electric parts) | | | |
| Ambient Temperature | | °C | Operating: -25 +55 | Operating: -25 +55 | Operating: -25 +55 | | | |
| | | °C | Storage: -30 +70 | Storage: -30 +70 | Storage: -30 +70 | | | |
| Climate Withstand | | IEC 68 part 2-3 IEC 68 part 2-30 | Constant Hot Damp Cyclical Hot Damp | Constant Hot Damp Cyclical Hot Damp | Constant Hot Damp Cyclical Hot Damp | | | |
| Connections | Terminal Block Caliber | EN60947-1 | A6 | A8 | A2 | | | |
| | Terminal Screw | | M4 | M5 | M3,5 | | | |
| | Screwing Torque | EN60947-1 UL508 | 1,2 Nm 7 lb. in. (0,8 Nm) | 3 Nm 32,0 lb. in. (3,6 Nm) | 0,8 Nm 12 lb. in. | | | |
| Connectable Section | Flexible Conductors n°1 min/max | mm² AWG | 1,5 - 10 16 - 8 | 6 - 25 10 - 2 | 1 - 2,5 18 - 12 | | | |
| | Solid Conductors n°1 min/max | mm² AWG | 1,5 - 10 16 - 8 | 10 - 35 10 - 2 | 1 - 2,5 18 - 12 | | | |
| Contacts | | | Slow opening Double-Break | Slow opening Double-Break | Slow opening Double-Break Positive opening for NC ➤ | | | |
| Opening Angles | | | 90° | 90° | - | | | |
| Mechanical Lifetime | | nr. of cycles | 100.000 | 100.000 | 1.500.000 | | | |
| at 120 operations per hour | | | | | | | | |
| Maximum Altitude | Until 2000 mt | Derating | Standard | Standard | - | | | |
| | Over 2000 mt | Voltage Derating (V) Power Derating (A) | < 1% ogni 100 m < 1% ogni 1000 m | < 1% ogni 100 m < 1% ogni 1000 m | - - | | | |
| | | | | | | | | |
| CERTIFICATIONS | | | SE 16 | SE 32 | SE 63 | SE 80 | SE 100 | AUXILIARY CONTACTS |
| CE | CE Mark - Europe | | ■ | ■ | ■ | ■ | ■ | ■ |
| cUL | cUL Listed - USA and Canada | | ● | ● | ● | ● | ● | ● |
| IMQ | Istituto Marchio Qualità (IMQ) - Italy | | ● | ● | ● | ● | ● | ● |
| CCC | CCC China | | ● | ● | ● | ● | ● | ● |
| EAC | EAC Russia | | ● | ● | ● | ● | ● | ● |

Rotary Disconnect Switch, SE Series, 2-3-4 Poles, Type R, Door or Thru Panel Mounting



| EN 60947-3 CHARACTERISTICS | | | SE16 | SE32 | SE63 | SE80 | SE100 | AUXILIARY CONTACTS |
|---|-------------|----------|--------------|--------------|----------|----------|---------|--------------------|
| Rated operating voltage Ue | V | | 690* | 690* | 690 | 690 | 690 | 690 |
| Rated insulation voltage Ui | V | | 690* | 690* | 690 | 690 | 690 | 690 |
| Rated impulse withstand voltage Uimp (sectionable) | kV | | 4* | 4* | 8 | 8 | 8 | 4 |
| Rated thermal current Ith | A | | (30*) 32 | 40* | 63* | 86* | 100 | 16 |
| Rated thermal current in enclosed Ithe | A | | (30*) 32 | 40* | 63* | 86* | 86 | 10 |
| Frequency | Hz | | 50 | 50 | 50 | 50 | 50 | 50/60 |
| RATED OPERATING CURRENT Ie: alternate current | | | SE16 | SE32 | SE63 | SE80 | SE100 | AUXILIARY CONTACTS |
| AC-21A Switching resistive loads with light overloads | 690V | A | (30*) 32 | (32*) 40 | 63* | 80* | 100 | AC-15 240V - 5A |
| AC-22A Switching mixed resistive and inductive loads at light overloads | 500V | A | - | - | - | - | 100 | DC-13 |
| AC-23A Periodic switching of motors 3 phases - 3 poles | 690V | A | (20*) 25 | 32* | 63* | 80* | 86 | 250V - 0,44A |
| | 230V | A/kW | 25/7,5 | 32/10 | 50/15 | 63/18,5 | 70/22 | - |
| | 400V | A/kW | 25/15 | 32/18,5 | 50/30 | 60/33 | 67/37 | - |
| | 500V | A/kW | 25/15 | 32/22 | 50/37 | 60/40 | 67/45 | - |
| AC3 Starting of cage motors (interruption hile running) 3 phases - 3 poles | 690V | A/kW | (16*)20/18,5 | 25*/22 | 32/30 | 35/33 | 38/37 | - |
| | 230V | A/kW | 22/7,5 | 30/9 | 40/11 | 50/15 | 60/18,5 | - |
| | 400V | A/kW | 22/11 | 30/15 | 40/22 | 50/25 | 55/30 | - |
| | 500V | A/kW | 22/11 | 30/18,5 | 40/30 | 50/33 | 55/37 | - |
| Nominal interruption power AC-23A (cosfi 0,45) | 690V | A/kW | (12*)22/11 | (20*)22/18,5 | 25/22 | 27/25 | 32/30 | - |
| | 230V | A | 200 | 256 | 400 | 504 | 560 | - |
| | 400V | A | 200 | 256 | 400 | 480 | 536 | - |
| | 500V | A | 200 | 256 | 400 | 480 | 536 | - |
| 690V | A | 160 | 200 | 256 | 280 | 304 | - | |
| SHORT CIRCUIT CHARACTERISTICS | | | SE16 | SE32 | SE63 | SE80 | SE100 | AUXILIARY CONTACTS |
| Rated short-time short circuit withstand current Icw (1 s) | A | | 400* | 400* | 1500 | 1500 | 1500 | - |
| Rated short circuit making capacity Icm | A | | 1500* | 1500* | 2840 | 2840 | 2840 | - |
| Conditional rated short circuit withstand current | kA | | 10* | 10* | 10* | 10* | 10 | 1 |
| Fuse rating gG | 500V | A | - | - | - | - | 100 | 10 |
| | 690V | A | 40* | 40* | (80*)63 | (80*) | - | - |
| UL 508 CHARACTERISTICS | | | SE16 | SE32 | SE63 | SE80 | SE100 | CONTATTI AUSILIARI |
| General Use | 600V AC | A | 32 | 40 | 63 | 80 | 100 | HD A600 AC Q600 DC |
| Standard motor load single phase - 2 poles | 120V AC | HP (FLA) | 1,5 (20) | 2 (24) | 3 (34) | 3 (34) | 3 (34) | - |
| | 200-208V AC | HP | 2 | 3 | - | - | - | - |
| Standard motor load 3 phases - 3 poles | 240V AC | HP (FLA) | 3 (17) | 5 (28) | 7,5 (40) | 7,5 (40) | 10 (50) | - |
| | 200-208V AC | HP | 7,5 | 10 | - | - | - | - |
| | 240V AC | HP (FLA) | 7,5 (22) | 10 (28) | 10 (28) | 10 (28) | 10 (28) | - |
| | 480V AC | HP (FLA) | 10 (14) | 15 (21) | 20 (27) | 25 (34) | 25 (34) | - |
| 600V AC | HP (FLA) | 15 (17) | 20 (22) | 25 (27) | 30 (32) | 30 (32) | - | |

Rotary Disconnect Switch, SE Series, 2-3-4 Poles, Type R, Door or Thru Panel Mounting

TYPE R

☛ Screw fixing.

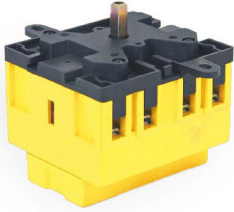

| SERIES | AC-21A | AC-23A | CODE | | |
|--------|-----------|-----------|------------|------------|------------|
| | AMP. 690V | AMP. 400V | 2 POLES | 3 POLES | 4 POLES |
| SE63 | 63 | 50 | SE630002R | SE630003R | SE630004R |
| SE80 | 80 | 60 | SE800002R | SE800003R | SE800004R |
| SE100 | 100 | 67 | SE1000002R | SE1000003R | SE1000004R |



2 POLES

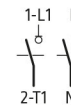



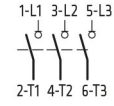

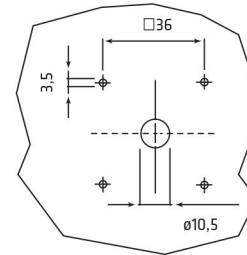
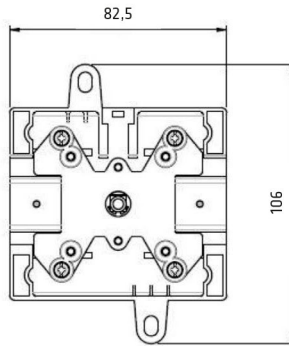
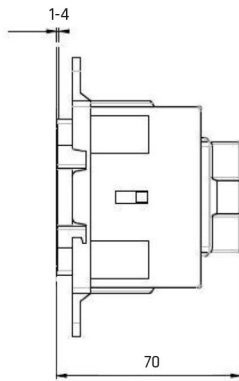
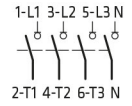

3 POLES



4 POLES

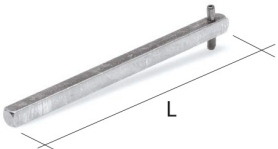

Panel

| <p style="text-align: center;">BOX FIXING PLATE</p>  <p style="text-align: center;">SE16 - SE32</p> <p style="text-align: center;">11814005</p> | <p style="text-align: center;">BOX SHAFT BF1/1NGO</p>  <p style="text-align: center;">SE16 - SE32</p> <p style="text-align: center;">11706237</p> | | | | | | | | | | | | |
|---|--|------------------------------|-------------|----------------|--------------------|------------------------------|----------|-----------|---|----------|----------|----------|--|
| <p style="text-align: center;">SHAFT EXTENSION FOR DOOR INTERLOCK</p>  <table border="1" style="width: 100%; text-align: center;"> <thead> <tr> <th></th> <th>□5</th> <th>□6</th> </tr> </thead> <tbody> <tr> <td></td> <td>SE16 - SE32</td> <td>SE63 - SE80 SE100</td> </tr> <tr> <td>L 185 mm</td> <td>20401089</td> <td>20900010</td> </tr> <tr> <td>L 300 mm</td> <td>20401164</td> <td>20900011</td> </tr> </tbody> </table> | | □5 | □6 | | SE16 - SE32 | SE63 - SE80 SE100 | L 185 mm | 20401089 | 20900010 | L 300 mm | 20401164 | 20900011 | <p style="text-align: center;">TERMINAL PROTECTION</p>  <p style="text-align: center;">2 pieces</p> <p style="text-align: center;">SE63 - SE80 - SE100 / 4 poles Box & Panel Mounting</p> <p style="text-align: center;">20900003</p> |
| | □5 | □6 | | | | | | | | | | | |
| | SE16 - SE32 | SE63 - SE80 SE100 | | | | | | | | | | | |
| L 185 mm | 20401089 | 20900010 | | | | | | | | | | | |
| L 300 mm | 20401164 | 20900011 | | | | | | | | | | | |
| <p style="text-align: center;">AUXILIARY CONTACTS</p>  <table border="1" style="width: 100%; text-align: center;"> <thead> <tr> <th colspan="2">SE16 - SE32</th> </tr> <tr> <th>CODE</th> <th>DIAGRAM</th> </tr> </thead> <tbody> <tr> <td>PL004001</td> <td>1NC 1 — 2</td> </tr> <tr> <td>PL004002</td> <td>1NO 3 — 4</td> </tr> </tbody> </table> | SE16 - SE32 | | CODE | DIAGRAM | PL004001 | 1NC 1 — 2 | PL004002 | 1NO 3 — 4 | <p style="text-align: center;">AUXILIARY CONTACTS FIXING PLATE</p>  <p style="text-align: center;">SE16 - SE32</p> <p style="text-align: center;">11814021</p> <p>The sale of these two accessories is matched for the correct use of the product.</p> | | | | |
| SE16 - SE32 | | | | | | | | | | | | | |
| CODE | DIAGRAM | | | | | | | | | | | | |
| PL004001 | 1NC 1 — 2 | | | | | | | | | | | | |
| PL004002 | 1NO 3 — 4 | | | | | | | | | | | | |